



F 819 S - FE - 8 x 19 Seale + fibre core 1570 N/mm² ungalvanized

Part Number	Application	Rope size mm	Stranding	Construction	Right lay	Min. breaking load kN	Calculated mass kg/m
621208010	Hoist	8	8 x 19	Seale	Regular	29.4	0.215
621209010	Hoist	9	8 x 19	Seale	Regular	37.4	0.270
621210010	Hoist	10	8 x 19	Seale	Regular	46.5	0.340
621211010	Hoist	11	8 x 19	Seale	Regular	56.4	0.411
621212010	Hoist	12	8 x 19	Seale	Regular	66.8	0.488
621213010	Hoist	13	8 x 19	Seale	Regular	79.3	0.579
621216010	Hoist	16	8 x 19	Seale	Regular	119.3	0.871

Component Specifications

Preforming

All wire rope is preformed and complies with DIN EN 12385 and ISO 4344.

F 819 S - FE DT - 8 x 19 Seale + fibre core 1370/1770 N/mm² ungalvanized

621108010	Hoist	8	8 x 19	Seale	Regular	28.6	0.220
621109010	Hoist	9	8 x 19	Seale	Regular	35.9	0.280
621110010	Hoist	10	8 x 19	Seale	Regular	44.1	0.350
621111010	Hoist	11	8 x 19	Seale	Regular	54.0	0.430
621112010	Hoist	12	8 x 19	Seale	Regular	64.1	0.500
621113010	Hoist	13	8 x 19	Seale	Regular	74.9	0.590
621116010	Hoist	16	8 x 19	Seale	Regular	113.0	0.890

PAWO F3 - 8 x 19 Seale + IWRC 1570 N/mm² ungalvanized

761208030	Hoist	8	8 x 19	Seale / IWRC	Regular	36.2	0.240
761209030	Hoist	9	8 x 19	Seale / IWRC	Regular	46.0	0.307
761210030	Hoist	10	8 x 19	Seale / IWRC	Regular	57.6	0.385
761211030	Hoist	11	8 x 19	Seale / IWRC	Regular	69.9	0.466
761212030	Hoist	12	8 x 19	Seale / IWRC	Regular	82.7	0.551
761213030	Hoist	13	8 x 19	Seale / IWRC	Regular	98.2	0.656
761216030	Hoist	16	8 x 19	Seale / IWRC	Regular	147.2	0.984

PAWO F7 - 8 x 19 Warrington + IWRC 1570 N/mm² ungalvanized

631208030	Hoist	8	8 x 19	Warrington / IWRC	Regular	38.7	0.258
631209030	Hoist	9	8 x 19	Warrington / IWRC	Regular	49.3	0.329
631210030	Hoist	10	8 x 19	Warrington / IWRC	Regular	60.4	0.403
631211030	Hoist	11	8 x 19	Warrington / IWRC	Regular	73.1	0.488
631212030	Hoist	12	8 x 19	Warrington / IWRC	Regular	86.4	0.576
631213030	Hoist	13	8 x 19	Warrington / IWRC	Regular	100.0	0.671
631216030	Hoist	16	8 x 19	Warrington / IWRC	Regular	152.8	1.020

PAWO F10 - 9 x 17 filler + IWRC 1570 N/mm² ungalvanized

721208031	Hoist	8	9 x 17	Filler / IWRC	Regular	39.6	0.280
721209031	Hoist	9	9 x 17	Filler / IWRC	Regular	50.4	0.350
721210031	Hoist	10	9 x 17	Filler / IWRC	Regular	61.6	0.430
721211031	Hoist	11	9 x 17	Filler / IWRC	Regular	74.2	0.520
721212031	Hoist	12	9 x 17	Filler / IWRC	Regular	89.2	0.630

PAWO F10 - 9 x 21 filler + IWRC 1570 N/mm² ungalvanized

721213031	Hoist	13	9 x 21	Filler / IWRC	Regular	105.6	0.750
721216031	Hoist	16	9 x 21	Filler / IWRC	Regular	161.0	1.140

6 x 19 + FE - 6 x 19 + fibre core 1770 N/mm² ungalvanized - DIN EN 12385

601306010	Governor	6	6 x 19	Standard	Regular	19.6	0.122
601306510	Governor	6.5	6 x 19	Standard	Regular	22.1	0.137
601308010	Governor	8	6 x 19	Standard	Regular	35.6	0.219

Most items are in stock - others available with short lead times.

NOTE: Gustav Wolf wire rope is not available from Draka EP in the United Kingdom or Turkey.

Wire Rope Accessories

DIN 43148 wedge sockets

Part Number	Rope size	Dimension D diameter	Dimension L nominal	Dimension R nominal
WSY1-43148-67	6 - 7 mm	12 mm*	430 mm	300 mm
WSY1-43148-8	8 mm	12 mm*	430 mm	300 mm
WSY1-43148-912	9 - 12 mm	12 mm*	430 mm	300 mm
WSY1-43148-1012	10 - 12 mm	16 mm	440 mm	300 mm
WSY1-43148-1214	12 - 14 mm	16 mm	440 mm	300 mm
WSY1-43148-1215	12 - 15 mm	20 mm*	590 mm	400 mm
WSY1-43148-1620	16 - 20 mm	27 mm*	740 mm	500 mm
* screwheads are not per DIN 444				
WSY2-43148-67	6 - 7 mm	12 mm	430 mm	300 mm
WSY2-43148-8	8 mm	12 mm	430 mm	300 mm
WSY2-43148-912	9 - 12 mm	12 mm	430 mm	300 mm
WSY2-43148-1012	10 - 12 mm	16 mm	440 mm	300 mm
WSY2-43148-1214	12 - 14 mm	16 mm	440 mm	300 mm
WSY2-43148-1215	12 - 15 mm	20 mm	590 mm	400 mm
WSY2-43148-1620	16 - 20 mm	27 mm	740 mm	500 mm
WSY3-43148-67	6 - 7 mm	44 mm	430 mm	167 mm
WSY3-43148-8	8 mm	44 mm	430 mm	167 mm
WSY3-43148-912	9 - 12 mm	44 mm	430 mm	167 mm
WSY3-43148-1012	10 - 12 mm	44 mm	440 mm	173 mm
WSY3-43148-1214	12 - 14 mm	44 mm	440 mm	173 mm
WSY3-43148-1215	12 - 15 mm	50 mm	590 mm	201.5 mm
WSY3-43148-1620	16 - 20 mm	65 mm	740 mm	254 mm
WSY4-43148-67	6 - 7 mm	50 mm	430 mm	51 mm
WSY4-43148-8	8 mm	50 mm	430 mm	51 mm
WSY4-43148-912	9 - 12 mm	50 mm	430 mm	51 mm
WSY4-43148-1012	10 - 12 mm	57 mm	440 mm	59 mm
WSY4-43148-1214	12 - 14 mm	57 mm	440 mm	59 mm
WSY4-43148-1215	12 - 15 mm	68 mm	590 mm	65 mm
WSY5-43148-67	6 - 7 mm	50 mm	430 mm	79 mm
WSY5-43148-8	8 mm	50 mm	430 mm	79 mm
WSY5-43148-912	9 - 12 mm	50 mm	430 mm	79 mm
WSY5-43148-1012	10 - 12 mm	57 mm	440 mm	87 mm
WSY5-43148-1214	12 - 14 mm	57 mm	440 mm	87 mm
WSY5-43148-1215	12 - 15 mm	68 mm	590 mm	93 mm
WSY6-43148-67	6 - 7 mm	50 mm	430 mm	107 mm
WSY6-43148-8	8 mm	50 mm	430 mm	107 mm
WSY6-43148-912	9 - 12 mm	50 mm	430 mm	107 mm
WSY6-43148-1012	10 - 12 mm	57 mm	440 mm	115 mm
WSY6-43148-1214	12 - 14 mm	57 mm	440 mm	115 mm
WSY6-43148-1215	12 - 15 mm	68 mm	590 mm	121 mm

WSY1-43148

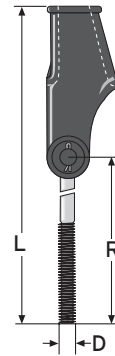

WSY2-43148

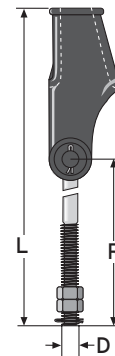

WSY3-43148

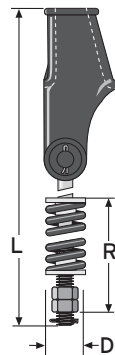

WSY4-43148

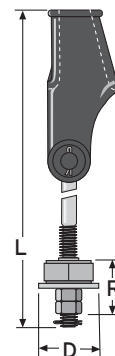

WSY5-43148

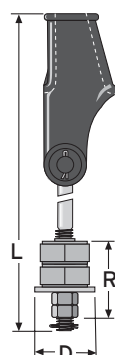

WSY6-43148

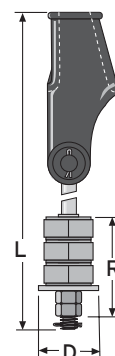

Component Specifications

Wedge socket
These items conform to DIN 43148

Wire Rope Accessories

DIN 15315 wedge sockets

Part Number	Rope size	Dimension D diameter	Dimension L nominal	Dimension R nominal
WSY-15315-5A	4 - 5 mm	10 mm	276 mm	180 mm
WSY-15315-65A	5 - 6,5 mm	10 mm	265 mm	180 mm
WSY-15315-8A	6 - 8 mm	12 mm	450 mm	320 mm
WSY-15315-11A	9 - 11 mm	16 mm	484 mm	320 mm
WSY-15315-14A	12 - 14 mm	20 mm	598 mm	400 mm
WSY-15315-17A	15 - 17 mm	24 mm	674 mm	450 mm
WSY-15315-20A	18 - 20 mm	27 mm	760 mm	500 mm
WSY-15315-5AM	4 - 5 mm	10 mm	276 mm	180 mm
WSY-15315-65AM	5 - 6,5 mm	10 mm	265 mm	180 mm
WSY-15315-8AM	6 - 8 mm	12 mm	450 mm	320 mm
WSY-15315-11AM	9 - 11 mm	16 mm	484 mm	320 mm
WSY-15315-14AM	12 - 14 mm	20 mm	598 mm	400 mm
WSY-15315-17AM	15 - 17 mm	24 mm	674 mm	450 mm
WSY-15315-20AM	18 - 20 mm	27 mm	760 mm	500 mm
WSY-15315-5D	4 - 5 mm	23 mm	276 mm	85.5 mm
WSY-15315-65D	5 - 6,5 mm	23 mm	265 mm	85.5 mm
WSY-15315-8D	6 - 8 mm	44 mm	450 mm	167 mm
WSY-15315-11D	9 - 11 mm	44 mm	484 mm	173 mm
WSY-15315-14AM	12 - 14 mm	53 mm	598 mm	201.5 mm
WSY-15315-17AM	15 - 17 mm	65 mm	674 mm	248 mm
WSY-15315-20AM	18 - 20 mm	65 mm	760 mm	254 mm
WSY-15315-8FP	6 - 8 mm	50 mm	450 mm	51 mm
WSY-15315-11FP	9 - 11 mm	58 mm	484 mm	59 mm
WSY-15315-14FP	12 - 14 mm	68 mm	598 mm	65 mm
WSY-15315-17FP	15 - 17 mm	80 mm	674 mm	74 mm
WSY-15315-8FP2	6 - 8 mm	50 mm	450 mm	79 mm
WSY-15315-11FP2	9 - 11 mm	58 mm	484 mm	87 mm
WSY-15315-14FP2	12 - 14 mm	68 mm	598 mm	93 mm
WSY-15315-17FP2	15 - 17 mm	80 mm	674 mm	102 mm
WSY-15315-8FP3	6 - 8 mm	50 mm	450 mm	107 mm
WSY-15315-11FP3	9 - 11 mm	58 mm	484 mm	115 mm
WSY-15315-14FP3	12 - 14 mm	68 mm	598 mm	121 mm
WSY-15315-17FP3	15 - 17 mm	80 mm	674 mm	130 mm

Pulling grips - galvanized steel with rotating eye

Part Number	For Wire Rope Diameters	Weave length	MBL kN
03302016	0.63 - 1.24 cm	66 cm weave length	20.5
03302018	1.27 - 1.88 cm	81 cm weave length	44.4
03302044	0.63 - 1.24 cm	66 cm weave length	20.5
03302046	1.27 - 1.88 cm	81 cm weave length	44.4



WSY1-15315

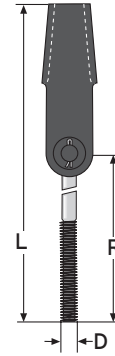

WSY2-15315

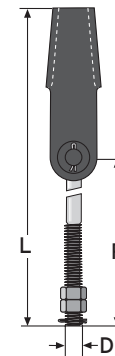

WSY3-15315

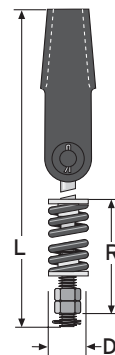

WSY4-15315

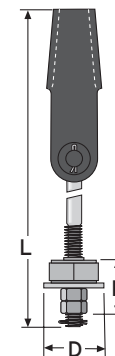

WSY5-15315

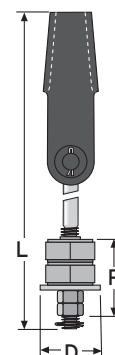

WSY6-15315

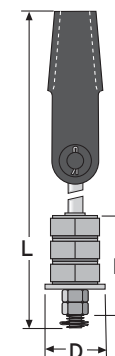

Component Specifications

Wedge socket

These items conform to DIN 15315